

INTERIOR 3D SERVICES

CREATED FOR:

The Design, Building Industry and Realtor Industry.

PREPARED BY:

Power House Plans
www.powerhouseplans.com

SA - Glenn Lewis
+27 82 868 2728
glewis@powerhouseplans.com

CA - Kim Jansen
+1 236 990 8736
kjansen@powerhouseplans.com



COVER LETTER

I Thank you for the time in reviewing our 3d Interior Design Services.

We are Power House Plans, a remote company founded in 2021, based in both South Africa - Cape Town and Canada - Vancouver. We serve our clients with first rate and superior designs both internationally and locally. We are passionate and driven by our love of innovation, inspirational and astute design skills. All our work is engineered and distributed remotely. Mainly serving clients in the residential industry.

Our team consists of architectural technicians, engineers, and art enthusiasts with a keen ocular perceiver for style and design.

In this proposal, you will find information pertaining to Power House Plans, our services offered and sample imagery - there are live links embedded that invite you to immerse yourself in our work and visualizations. So please be sure to be connected to the Internet upon reviewing our proposal.

We look forward to the possibility of doing business with you.

Sincerely,

Glenn Lewis

Director
Power House Plans
+27 82 868 2728
Geiws@powerhouseplans.com
www.powerhouseplans.com

INDEX

3D Visualization	Pg.4	We provide 3d graphical representation of your home, adding a visualization for that perfect sale .
3D Floor Plans	Pg.5	3D Floor Plans are created from sketches or pictures taken from a home for sale
360° Virtual Visualization	Pg.6	We create Panorama Imagery for your clients to view their proposed designs.
Virtual Video Walk Throughs	Pg.7	Virtual Video Walk Throughs created, based on your clients needs and preferences.
Interior Home Staging	Pg.8	We enhance the interior environment of your home, room, building, restaurant, hospital, bars, hotels, and office.
Scope of work & timeline	Pg.9	What we will need from you in order to create this amazing imagery, and the time frame of our deliverables.
Pricing & Fees		We have proposed set packages based on your 3D design needs.
Final Words	Pg.10	A conclusion to sum up the finer details.

3D VISUALIZATION & Rendering styles

- Standard:



- Technical illustration



- Glass House

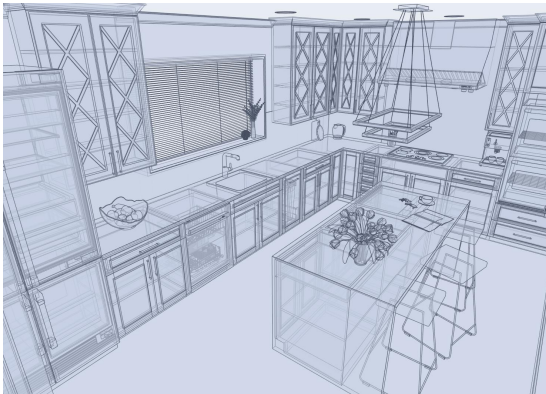

- Line drawing



- Virtual



- Virtual Plan View



- Line Drawing - Plan View

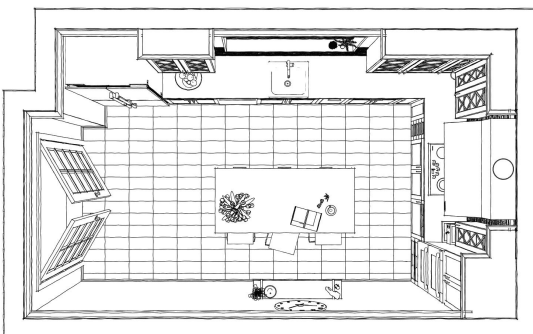

- Glass House - Plan View

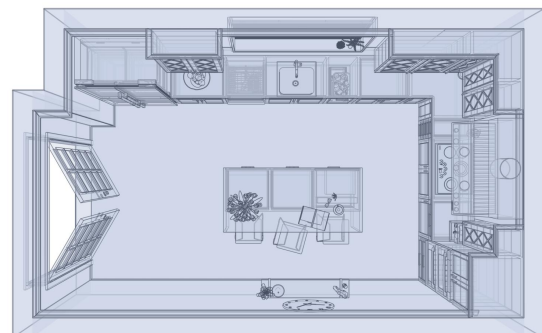

3D FLOOR PLANS

- 3D Floor Plans creates a perspective overview of the home where you can see and feel the space of a home, allowing space planning - in a sense allowing you to mentally move in without even making a visit to the sale home. Tailored to your companies needs.



Your Logo here

Floor Area: Interior - 1141 sq.ft / Balcony- 107 sq.ft



PROPERTY:
807 Orlean's Ridge
Coquitlam

Plan is for illustrative and Realtor purposes only and is not to scale. All room sizes and dimensions shown on this plan including but not limited to doors, windows and cabinets are approximate. No responsibility is taken for errors contained in this document, all information provided should not be relied upon.
Plan by ©PowerHousePlans (Pty) Ltd. Unauthorized reproduction prohibited. Drawing Ref:CA-P-0000 / kjansen@powerhouseplans.com /

Pg 2

360° VIRTUAL VISUALIZATION

click on image to view 360

- Our Virtual Panorama Images are showcased on our Partner website. Private access will be given to you, which you may then share with your clients. All products hosted on our partner website will be accessible for 60 days

Mediterranean Kitchen



Proposed Home



Modern Kitchen



Proposed Garage



Contemporary Kitchen



VIRTUAL VIDEOS

click on image to play Video

- Complete House Walk Through Video

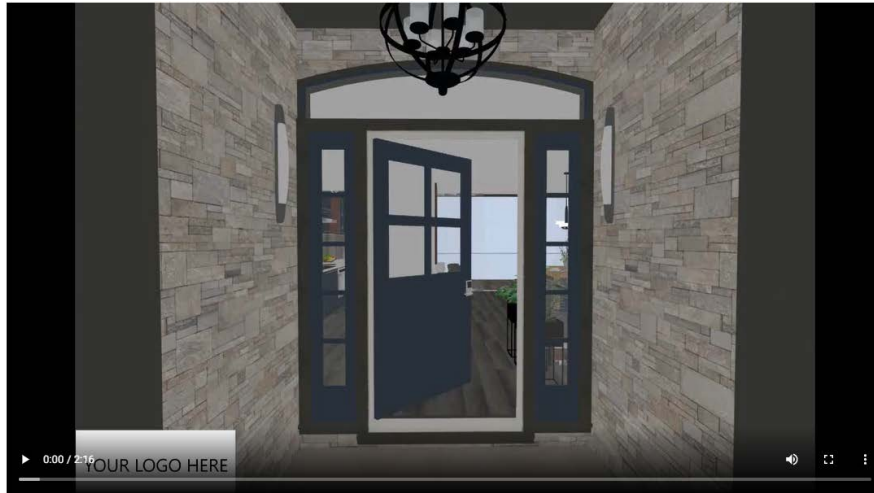

[View on PowerHousePlans.com](https://www.powerhouseplans.com)

- Single Room Walk Through - various render styles



[View on PowerHousePlans.com](https://www.powerhouseplans.com)

INTERIOR HOME STAGING

At Power House Plans, we believe that a house becomes a home when it is personalized - Staging a home in the best possible manner gives a home taste and personality, allowing the prospective buyer to idealize their future home into great possibilities. Affording the seller an opportunity to present the home in its best possible light as it deserves to be.



TIMELINE

Task	Timeline
<u>Conceptualize:</u> This is the phase where we receive the floor plans and or sketches, your design or style you want to create, any supporting images (vision boards)	1 day
<u>Schematics:</u> We come back to you with pre delivery images, allowing you a revision for final delivery.	2 days
<u>Delivery:</u> Upon approved schematic revision - We will create the final visualizations of your choice, and this will be sent to you, as well as a link to 360 imagery viewable on our partner platform.	1 - 2 days

PRICING & FEES

For pricing please contact us for a personalized quotation to suite your requirements.

SA - Glenn Lewis
+27 82 868 2728
glewis@powerhouseplans.com

CA - Kim Jansen
+1 236 990 8736
kjansen@powerhouseplans.com

FINAL WORDS

CLIENT RESPONSIBILITIES & TIPS:

The client may not know the names of any styles or have a clue what a sideboard is, and that's A-OK. Flipping through real estate magazines and cruising design websites can provide an idea of what you like and dislike - a vision board is thus created. These inspirations will be able to assist us in creating your clients dream home.

KNOW YOUR RIGHTS:

We own our designs and images. Upon payment in full, these become owned fully by you. Final deliverables will not be released until notification of full payment is received. Power House Plans may use images in our company portfolio and on our website, but your name and address will never appear on any marketing media without your written consent.

TERMS & ACCEPTANCE:

All payment terms included in this proposal are estimates and may change as the scope of the project becomes more defined, any changes to this pricing structure will be submitted via email and approved prior to execution. We will create and submit new design fee estimates that reflect changes in scope when appropriate.

Thanks again for considering Power House Plans for your projects.